

BN

FEATURES

- Accuracy guaranteed to 0.003mm TIR (0.0001")
- Excellent for CNC and conventional machines.
- Heat-treated point to HRc 60±2.
- High performance lip seal and deflected shaft design protects bearing space (Double Angular Contact Bearing) from ingress by dust and coolant.
- Heat-treated body for extra strength, rigidity and long life.
- Carbide point available.
- Carbide point to HRa 90±5.

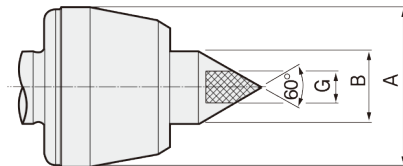
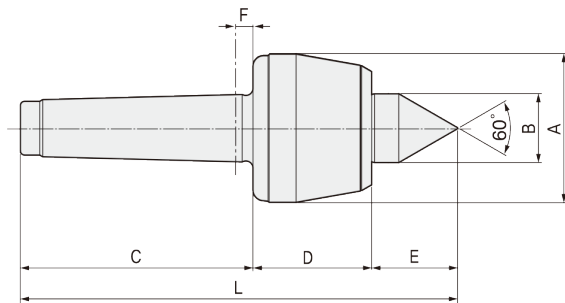

Available Carbide Tipped Points

BNC-TYPE

- MT2: 012002
- MT3: 012003
- MT4: 012004
- MT5: 012005
- MT6: 012006

Dimension

Unit: mm, kg

MODEL	MT	A	B	C	D	E	F	G	L	Workpiece Weight	Max, R.P.M	Weight	Max, Run Out
011002 (012002)	2	50	25	68	43.5	29.5	6	10	141	500	5,000	0.7	0.003
011003 (012003)	3	50	25	85	43.5	29.5	6	10	158	500	5,000	0.8	0.003
011004 (012004)	4	69	32	108	55	40	8	14	203	800	3,800	1.85	0.003
011005 (012005)	5	88	40	136	70	50.5	8	18	256.5	2,000	3,000	4.2	0.003
011006 (012006)	6	105	50	189	81.5	58.2	10	30	328.7	3,500	2,800	8.7	0.005

*(MODEL NO) : Carbide Tip Type

BN type Technical data

- 2,3BN
- 4BN
- 5BN
- 6BN

